



# SCV4100



## **THE BOSTON VALVE Co.**

---

A DIVISION OF BOSTON METAL PRODUCTS, LTD.  
25 THURBER BLVD., UNIT #3  
SMITHFIELD, RI 02917

TOLL FREE: 1-800-839-0013, TEL: 401-231-8537  
FAX: 401-231-8491  
[WWW.BOSTONVALVE.COM](http://WWW.BOSTONVALVE.COM)

# SCV4100 SERIES

## NPT SPRING CHECK VALVE

A high quality, cast brass, straight pattern, spring check valve with one piece body and soft seat.  
Rated at 200 WOG.

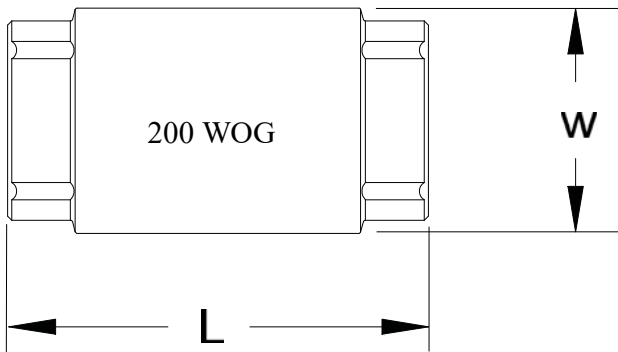
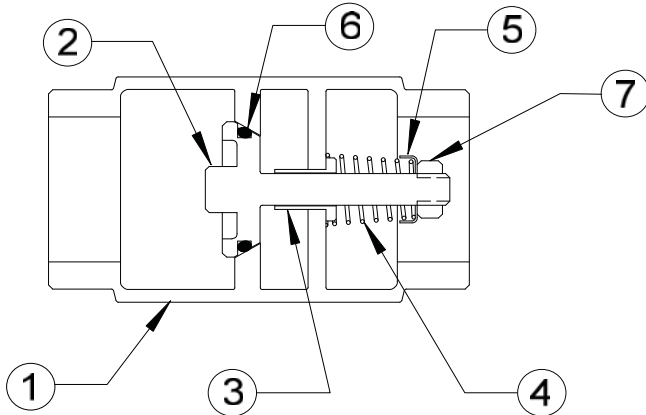

### DIMENSIONS

CAT. NO.	SIZE	L	W	LBS
SCV0504100	1/2	2.40	1.26	.43
SCV0754100	3/4	2.74	1.50	.59
SCV1004100	1	3.23	1.77	.86
SCV1254100	1 1/4	3.62	2.13	1.44
SCV1504100	1 1/2	4.04	2.36	1.54
SCV2004100	2	5.04	3.03	3.21

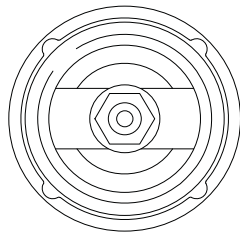

### MATERIAL LIST

NO.	PART NAME	MATERIAL
7	STEM NUT	BRASS (ASTM-UNS B16 C36000)
6	O-RING	RUBBER
5	SPRING RETAINER	STAINLESS STEEL (304)
4	SPRING	STAINLESS STEEL (304)
3	GUIDE	POLYACETAL (CF 500 P)
2	STEM/DISC	BRASS (ASTM-UNS B584 C85710)
1	BODY	BRASS (ASTM-UNS B584 C85710)