

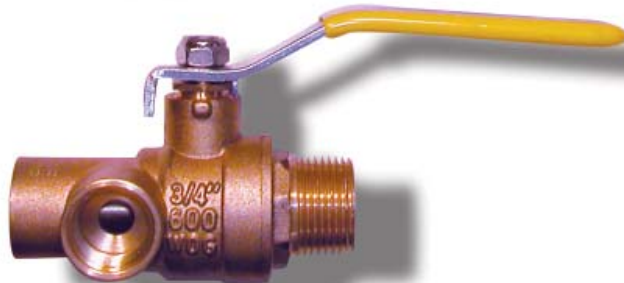

PV1000 PV2000 PV3000



# THE BOSTON VALVE Co.

---

A DIVISION OF BOSTON METAL PRODUCTS, LTD.  
25 THURBER BLVD., UNIT #3  
SMITHFIELD, RI 02917

TOLL FREE: 1-800-839-0013, TEL: 401-231-8537  
FAX: 401-231-8491  
WWW.BOSTONVALVE.COM

# PV1000, 2000 & 3000 SERIES PURGE BALL VALVE

A 600 WOG rated, two piece, full port, brass ball valve with 1/2" NPT purge port.

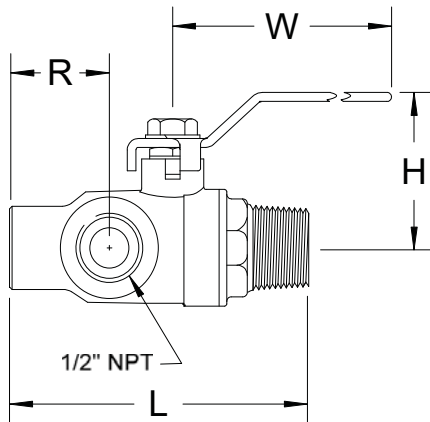

**PV1000**

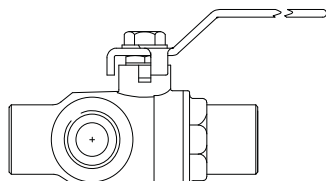
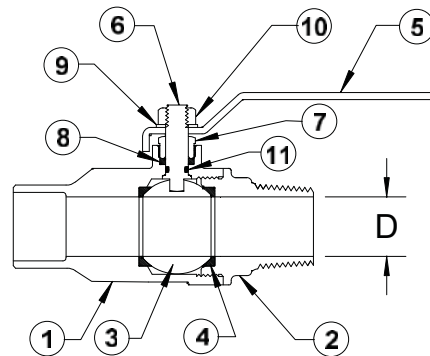

**PV2000**

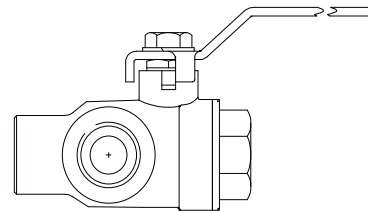

**PV3000**

## DIMENSIONS

CAT. NO.	SIZE	L	D	H	R	W
PV0751000	3/4	3.35	.75	2.17	1.08	4.65
PV1001000	1	3.78	.97	2.28	1.18	4.65
PV0752000	3/4	3.30	.75	2.17	1.08	4.65
PV1002000	1	3.78	.97	2.28	1.18	4.65
PV0753000	3/4	3.15	.75	2.17	1.08	4.65
PV1003000	1	3.59	.97	2.28	1.18	4.65

## MATERIALS

NO.	PART NAME	MATERIAL
11	O-RING	BUNA-N
10	NUT	STEEL, ZINC PLATED
9	LOCK WASHER	STEEL, ZINC PLATED
8	STEM PACKING	PTFE
7	GLAND NUT	BRASS
6	STEM	BRASS
5	HANDLE	STEEL, ZINC PLATED, PLASTICOATED
4	SEAT	PTFE
3	BALL	BRASS, HARD CHROME PLATE
2	END CAP	BRASS
1	BODY	BRASS