

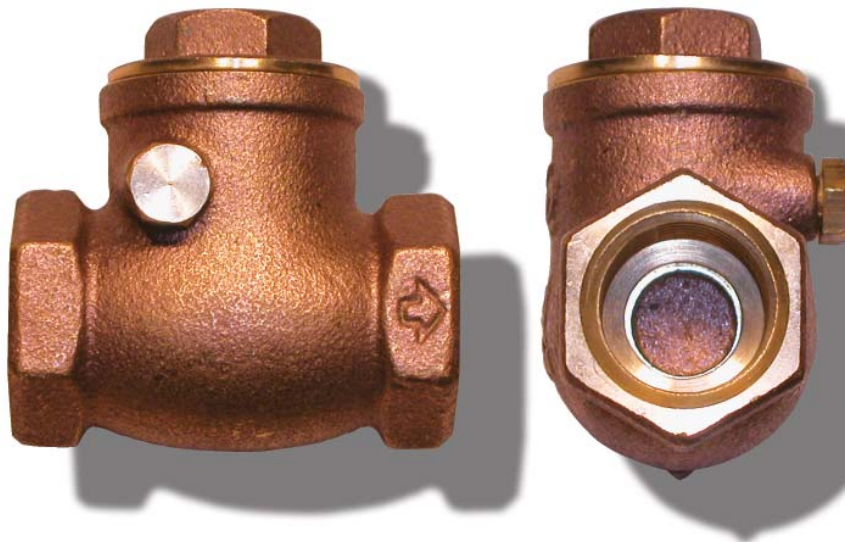

# CHV4100 CHV4100LF



## **THE BOSTON VALVE Co.**

---

A DIVISION OF BOSTON METAL PRODUCTS, LTD.  
25 THURBER BLVD., UNIT #3  
SMITHFIELD, RI 02917

TOLL FREE: 1-800-839-0013, TEL: 401-231-8537  
FAX: 401-231-8491  
[WWW.BOSTONVALVE.COM](http://WWW.BOSTONVALVE.COM)

# CHV4100 - CHV4100LF SERIES

## NPT SWING CHECK VALVE

A high quality, cast brass, straight pattern, swing check valve with screw cap and metal disk. Rated at 200 WOG.

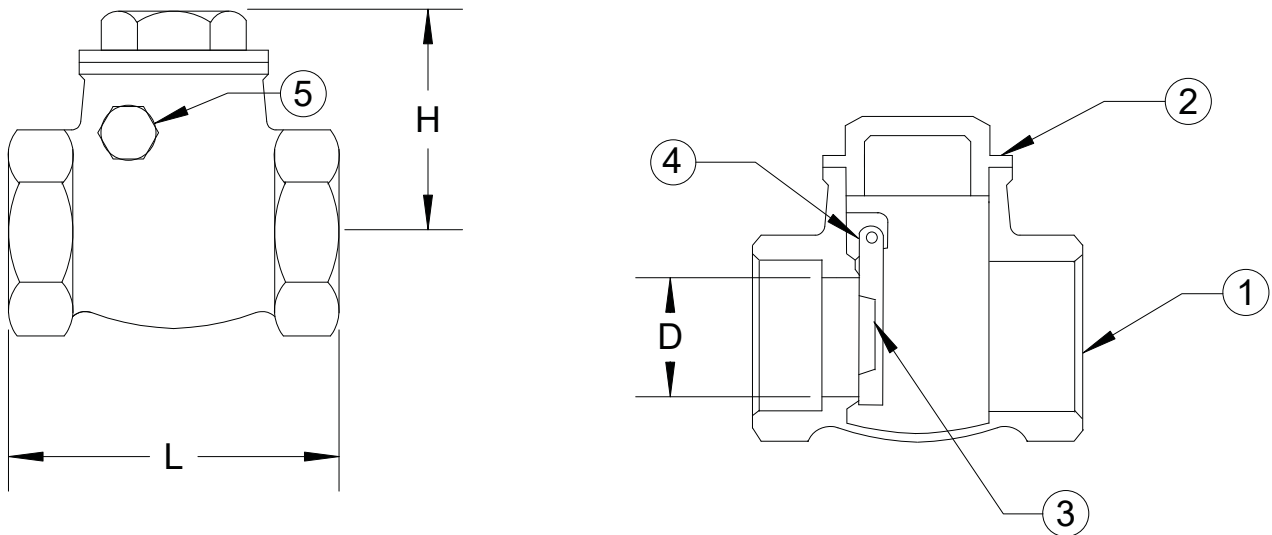

### DIMENSIONS

| CAT. NO.   | CAT. NO.     | SIZE  | L    | D    | H    |
|------------|--------------|-------|------|------|------|
| CHV0504100 | CHV0504100LF | 1/2   | 1.81 | .51  | 1.33 |
| CHV0754100 | CHV0754100LF | 3/4   | 2.20 | .70  | 1.47 |
| CHV1004100 | CHV1004100LF | 1     | 2.48 | .86  | 1.75 |
| CHV1254100 | CHV1254100LF | 1 1/4 | 2.65 | 1.14 | 1.96 |
| CHV1504100 | CHV1504100LF | 1 1/2 | 3.22 | 1.29 | 2.22 |
| CHV2004100 | CHV2004100LF | 2     | 3.70 | 1.65 | 2.53 |
| CHV2504100 | CHV2504100LF | 2 1/2 | 4.17 | 1.96 | 2.99 |
| CHV3004100 | CHV3004100LF | 3     | 4.98 | 2.44 | 3.22 |
| CHV4004100 | CHV4004100LF | 4     | 6.25 | 3.26 | 4.05 |

### MATERIAL LIST

| NO. | PART NAME | CHV MATERIAL                 | CHVLF MATERIAL |
|-----|-----------|------------------------------|----------------|
| 5   | LOCK BOLT | BRASS (ASTM-UNS B16 C36000)  | BRASS C46500   |
| 4   | PIN       | BRASS (ASTM-UNS B124 C37700) | BRASS C46500   |
| 3   | DISC      | BRASS (ASTM-UNS B584 C85710) | BRASS C46500   |
| 2   | CAP       | BRASS (ASTM-UNS B584 C85710) | BRASS C46500   |
| 1   | BODY      | BRASS (ASTM-UNS B584 C85710) | BRASS C46500   |